

Addressable Manual Call Point

General

The **RC-1W** addressable manual call point connect to addressable fire alarm control panel. Up to 300 devices can be connected to each loop of RCL-3100 fire alarm control panel. The device has an integral alarm indicator that illuminate when the manual call point has been pushed down.



Features

- DCP protocol for fast and robust communication
- Use standard cable, no shielded or twisted pair required on SLC loop
- Up to 300 devices can be used on per loop
- LED indicator can show normal · alarm status
- With emergence telephone jack
- Electronic address is easily to program by RCL-3100 panels or programmer tool

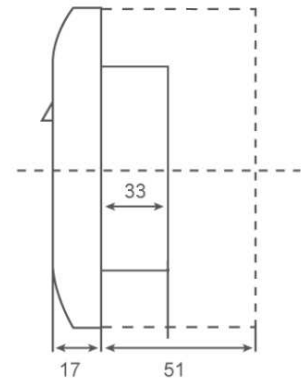

Specifications

Model	RC-1W
Operating Voltage	DC 18V ~ 30V
Quiescent current	1.2mA / DC 24V
Alarm current	10mA / DC 24V
LED indicator	Normal: flash one time per 6 seconds; Alarm: always on
Operating temperature	0°C ~ 50°C,
Relative humidity	< 95% RH, non-condensing
Material / color	Fire-proof plastics / Red
Dimensions	Φ140 x 50 mm



SAFETEK